

Heritage Snowdon

12.19m x 6.10m (40' x 20') - 2 bedroom 2 bathroom

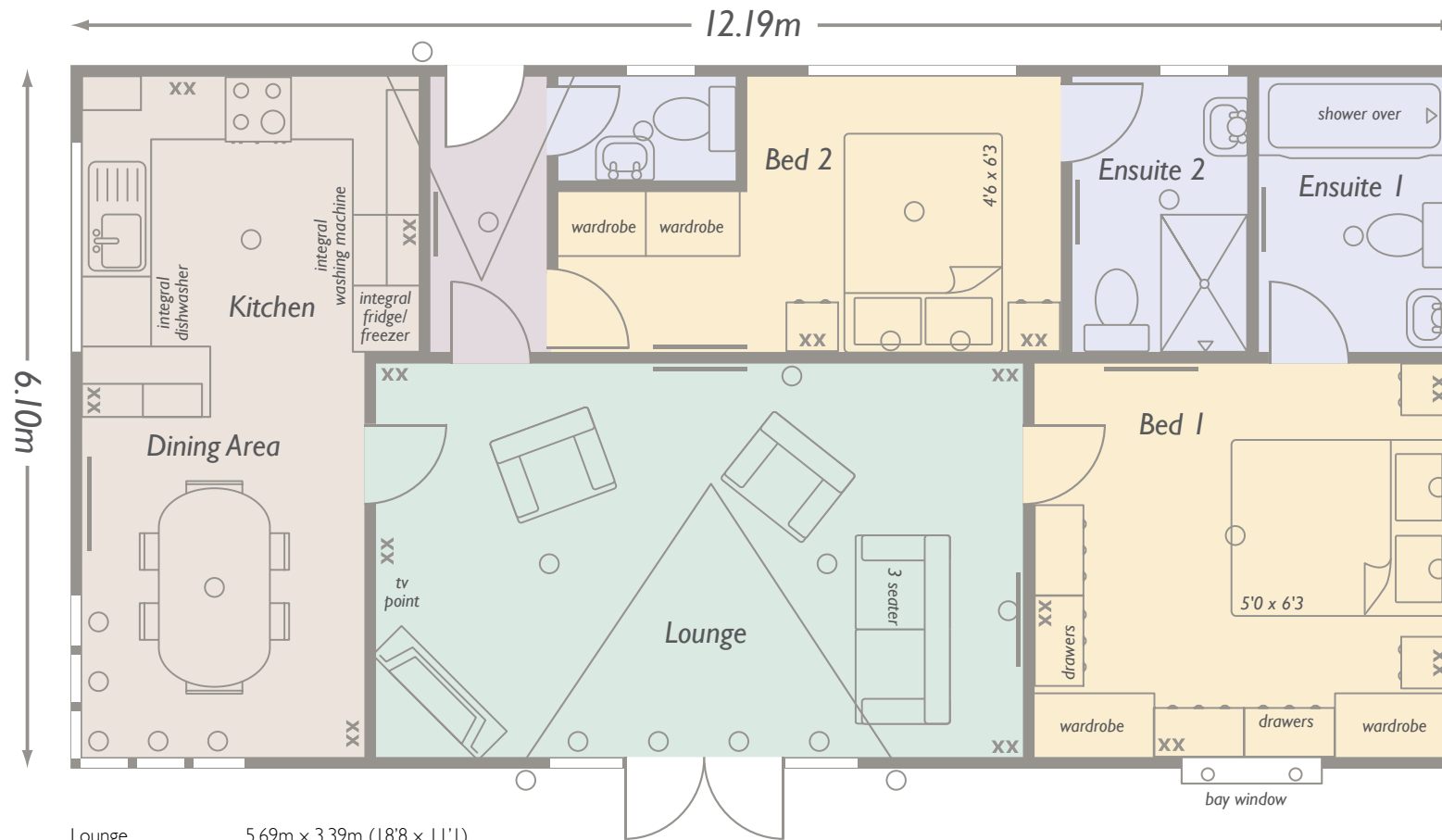

Lounge	5.69m x 3.39m (18'8 x 11'1)
Kitchen	2.94m x 2.94m (9'8 x 9'8)
Dining Area	2.43m x 2.94m (8'0 x 9'8)
Bedroom 1	3.65m x 3.39m (12'0 x 11'1)
Ensuite 1	1.68m x 2.40m (5'6 x 7'10)
Bedroom 2	2.74m x 2.40m (9'0 x 7'10)
Ensuite 2	1.52m x 2.40m (5'0 x 7'10)
W.C.	1.56m x 0.91m (5'1 x 3'0)

— Radiators * External tap xx Double sockets x Single sockets ○ Light fittings ◦ Recess lights ⊗ 3 way spotlight p/lights Pelmet lights



HERITAGE

Heritage Homes (Wales) Ltd, Unit D,
Penamser Business Park,
Porthmadog, Gwynedd LL49 9GB
Telephone: 01766 515 072
Email: sales@heritagehomes.co.uk
www.heritagehomes.co.uk